

# E1201AX1H1

---

Part number	E1201AX1H1
Structure	Vertical
Actuator configuration	Optional
Actuator length	Optional
Number of detent	Optional

---

Number of pulse	Optional
Push-on switch	With
Travel of push-on switch	0.5mm
Operating temperature range	-40°C~+85°C

---

## Electrical characteristics

Ratings	1mA 5V DC
Output signal	Two phase A and B
Max./min. operating current (Resistive load)	10mA/1mA
Insulation resistance	100M $\Omega$ min., 250V DC
Voltage proof	300V AC for 1 min. or 360V AC for 2s

---

## Mechanical characteristics

Rotational torque	10 $\pm$ 7mN.m
Push-pull strength	100N

---

## Push-on switch specifications

Contact arrangement	Single pole single throw (Push-on)
Travel	0.5 $\pm$ 0.3mm
Operating force	5 $\pm$ 1.5N
Ratings	0.1A 5V DC (500 $\mu$ A 5V DC min. ratings)
Contact resistance (Initial performance/After lifetime)	100m $\Omega$ max./200m $\Omega$ max.
Operating life	30,000 cycles

---

Durability	Operating life	30,000 cycles
MOQ		1,000pcs

## Photo

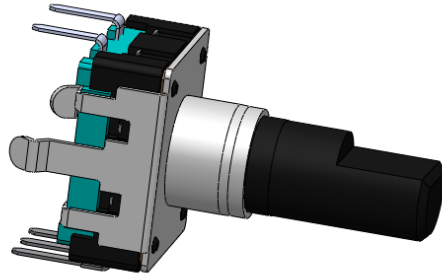

## Dimensions

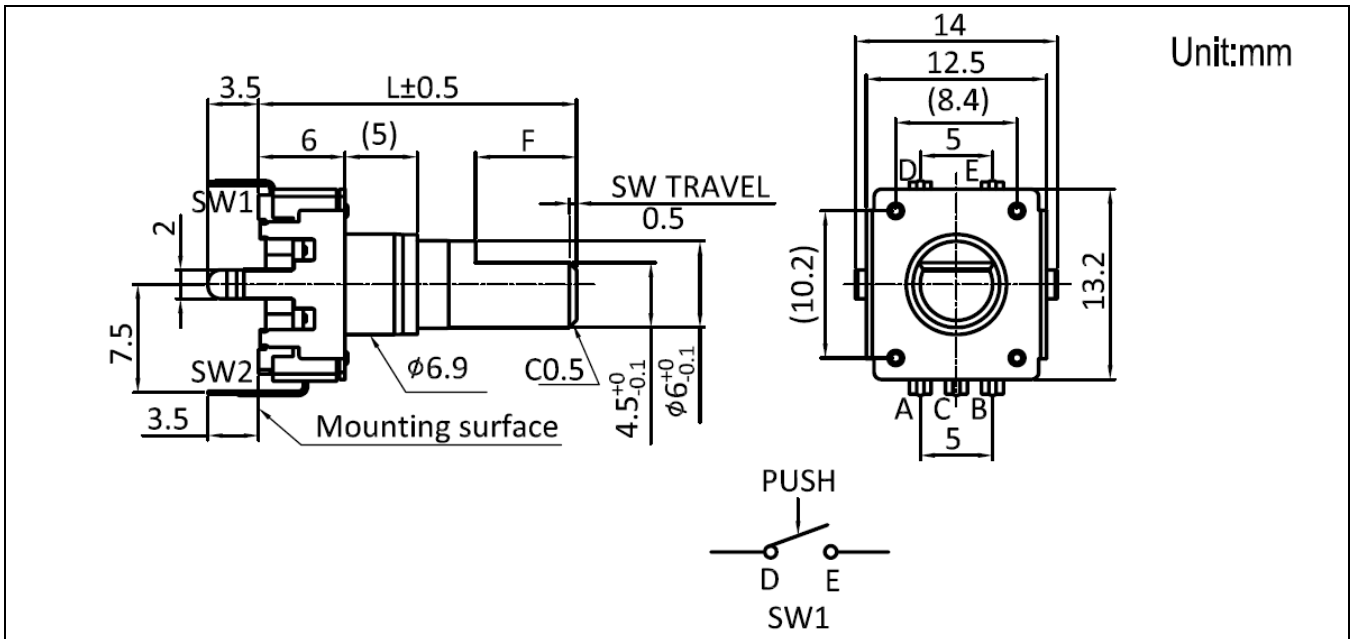

## Mounting Hole Dimensions

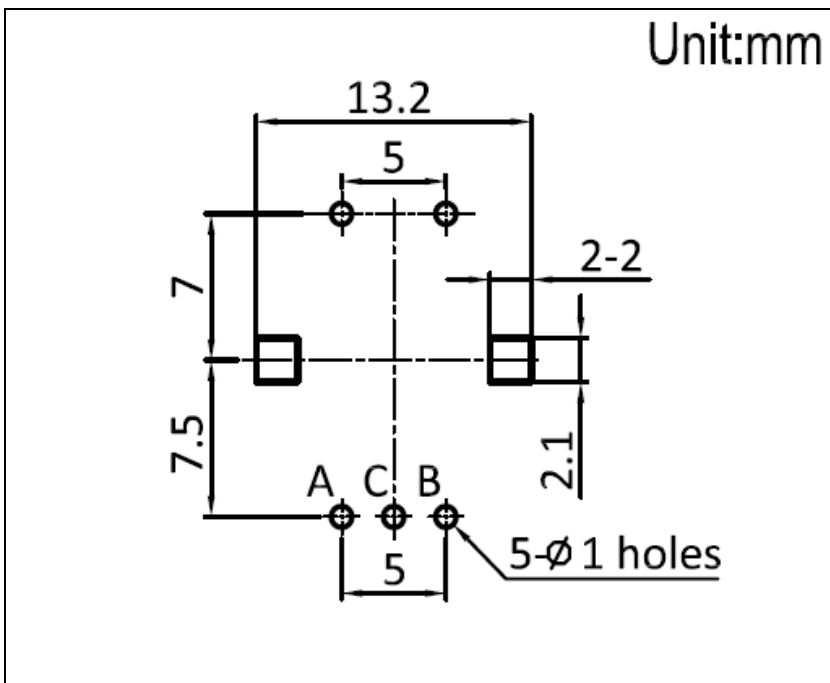

## Output Wave

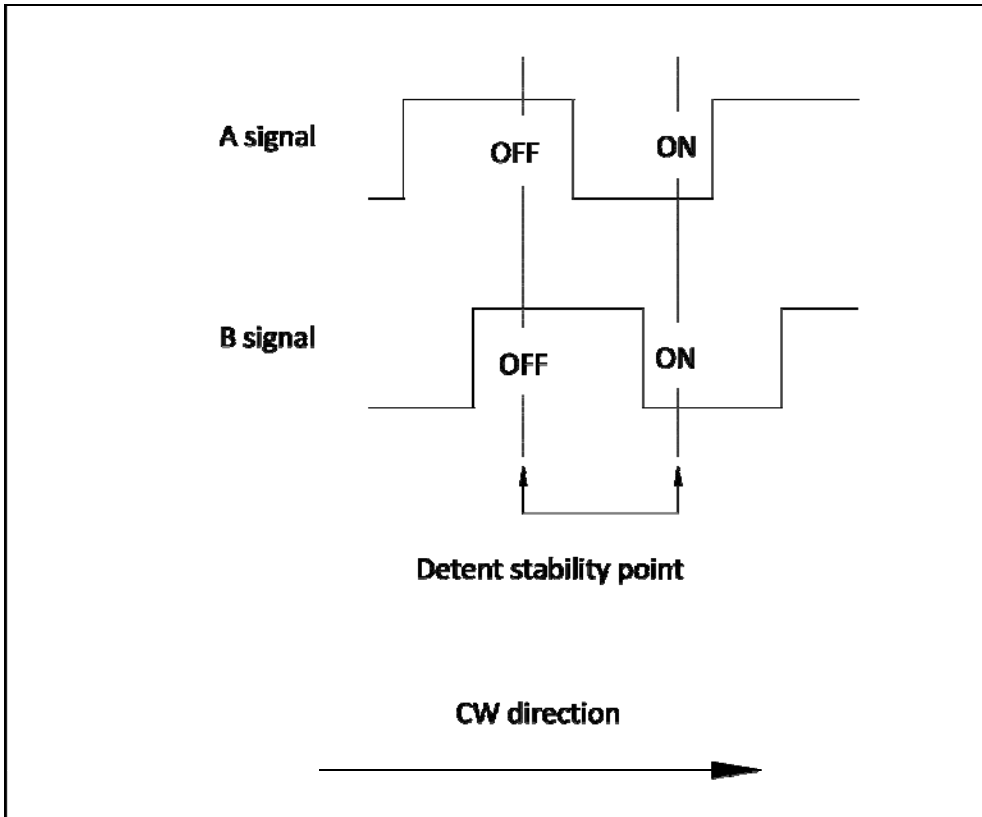

## Sliding Noise

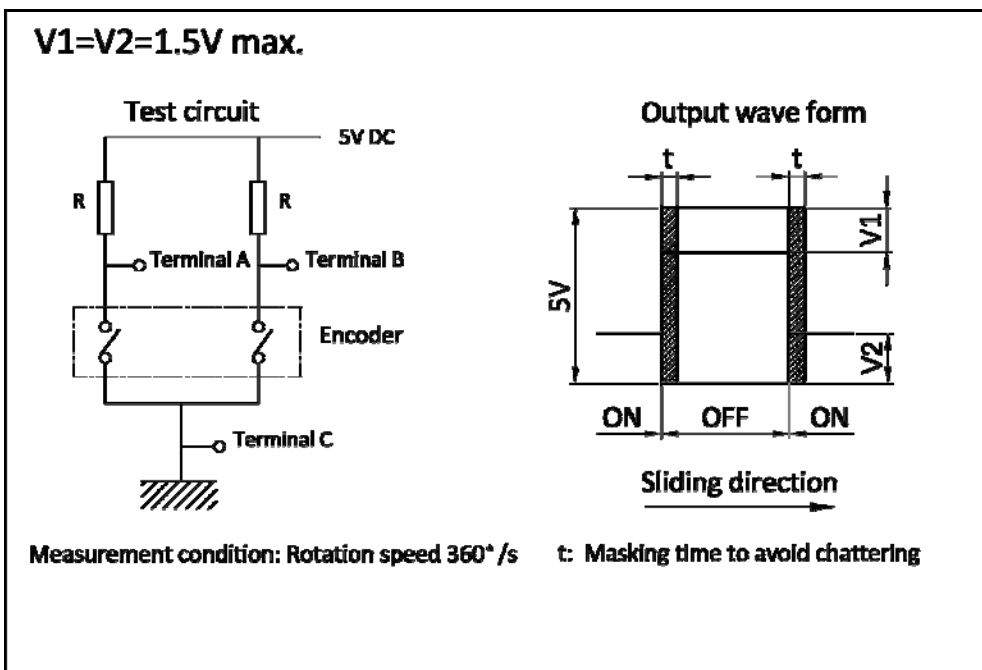

## Pulse and Detent Options

Pulse	Detent	Direction
12	12	F
	24	F
24	24	F

## Shaft and Shaft Length Options

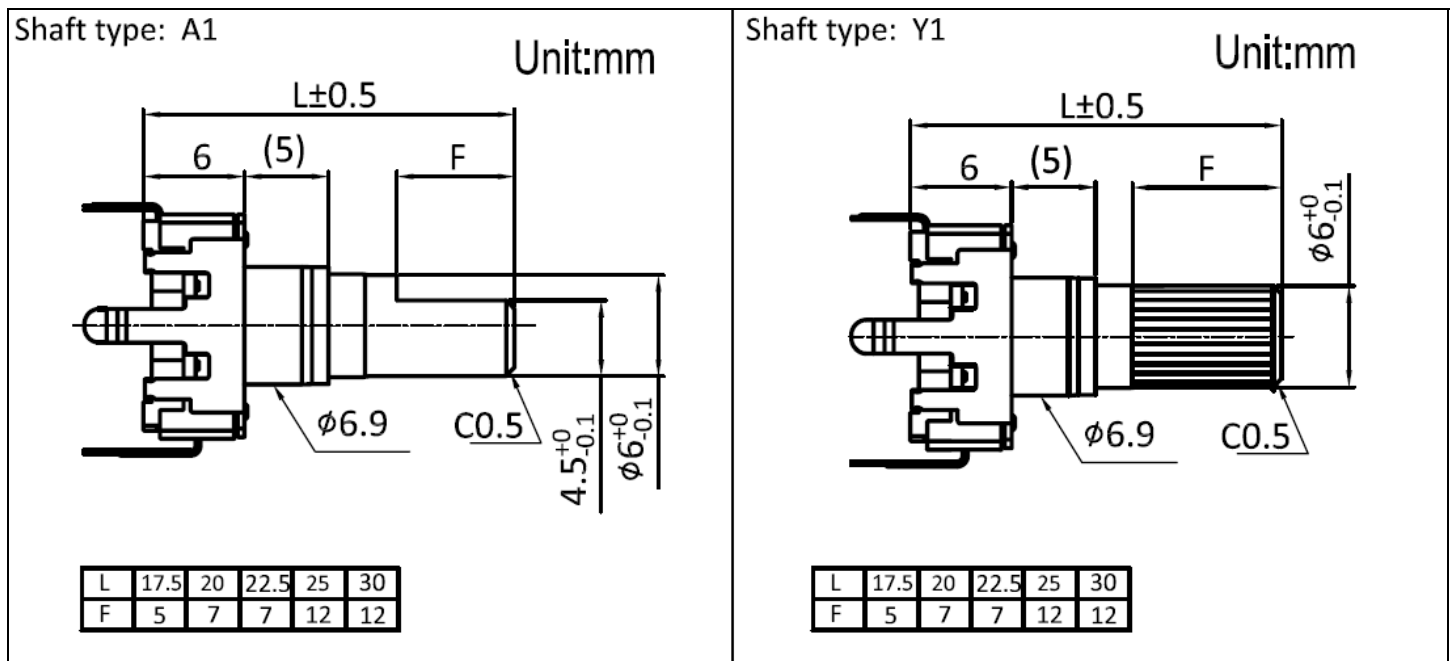

### Packing specifications

Quantity per carton	2,000pcs
Packing method	Foam box
Carton dimension	460X285X310mm

### Soldering conditions

#### Wave soldering

Soldering surface temperature	100°C max.
Heating time	2 min. max.
Soldering temperature	260°C ±5°C max.
Soldering time	5 ±1s
No. of solders	2 time max.

#### Hand soldering

Tip temperature	350°C max.
Soldering time	3s max.
No. of solders	1 time